

# Full Surface Rim Mount Strikes

## Introducing the 2650FR & 2675FR



**2650FR**



**2675FR**

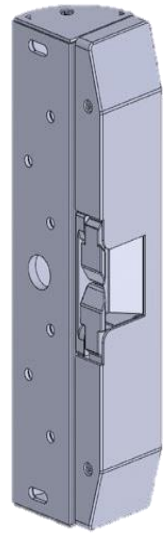

**2675-SMB**

The 2650FR & 2675FR are full surface rim mount strikes designed with strength and durability for rim exit devices with 1/2" and 3/4" pullman latch throws respectively. Both rim mount strikes are non-handed, dual voltage (12/24 VDC), and field reversible from fail-secure to fail-safe. Available in US32D or US19 finish. The 2675-SMB is a surface mount box. The strikes are UL listed.

### Features:

- No frame cutting required. Surface mounted. Horizontal adjustment
- Dual voltage 12/24 VDC field selectable
- Non-handed fully reversible
- Field reversible: fail safe or fail secure
- Static strength 1500 lbs (680 kg)
- Dynamic strength 70 ft-lbs
- Endurance 250,000 cycles UL tested. Factory tested 1,000,000 cycles
- Available in US32D or US19 finish
- Spacers included in pack:
  - **2650FR**: 2 of 1/8" (3mm)
  - **2675FR**: 3 of 1/16"; (1mm)
- **UL 1034** burglary resistant listed: BP10269
- **UL 294** Access Control System listed: BP10269
- **UL 10B/10C** Positive Pressure Fire Test of Door Assemblies